

1 Speed Drilling System Exploded View & Parts list

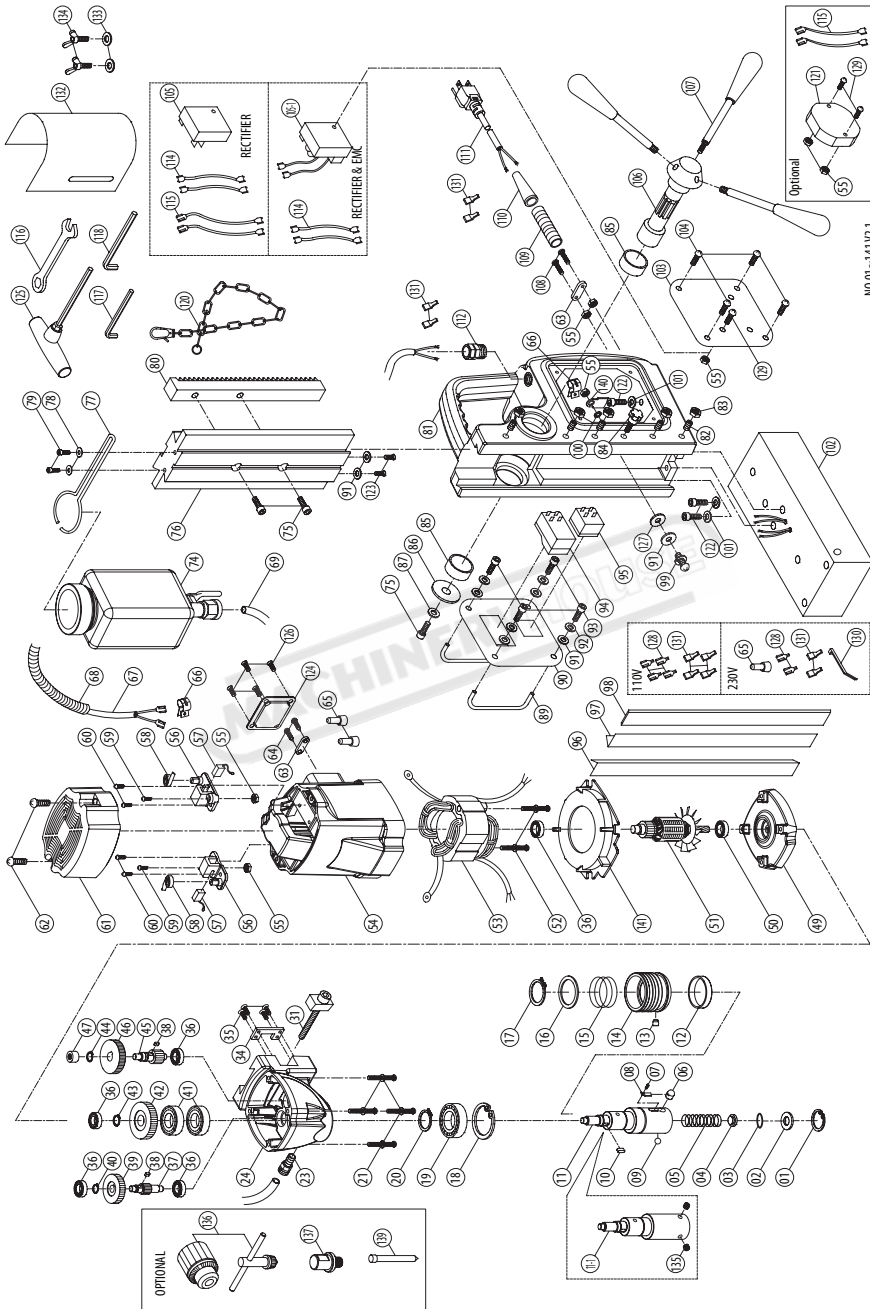

NO.	Parts Name	QTY	75	SOCKET CAP SCREW M6 x 16	3
1	INTERNAL CIRCLIP R-19	1	76	SLIDE	1
2	ARBOR WASHER Ø10 x Ø18.5 x 0.8	1	77	COOLANT TANK BRACKET	1
3	O-RING Ø12 x Ø20 x 4	1	78	FLAT WASHER Ø5 x Ø12 x 1	2
4	COOLANT SEAL	1	79	SOCKET CAP SCREW M5 x 16	2
5	SPRING Ø1.2 x Ø10.1 x Ø12.5 x 12T x 90L	1	80	GEAR RACK	1
6	LOCKING PIN 12.3mm	1	81	STAND BODY	1
6	LOCKING PIN 11.7mm	1	82	GIB SET SCREW M5 x 20	5
7	SET SCREW M3 x 4	1	83	GIB LOCK NUT M5	5
8	LOCKING PIN SPRING	1	84	THUMB SCREW M5 x 16	1
9	CHECK BALL Ø8	1	85	BUSHING Ø28 x Ø32 x 12	2
10	PARALLEL KEY 5 x 5 x 10	1	86	FLAT WASHER Ø6 x Ø40 x 2.5	1
11	SPINDLE	1	87	FLAT WASHER Ø6 x Ø25 x 1	1
11-1	SPINDLE	1	88	N/A	-
12	RING Ø40 x Ø44 x 9	1	89	SWITCH GUARD BAR	2
12	RING Ø40 x Ø44 x 9	1	90	SWITCH PANEL	1
13	COLLAR PIN	1	91	FLAT WASHER Ø4 x Ø10 x 1	7
14	QUICK-RELEASE COLLAR	1	92	SPRING WASHER M4	4
15	SPRING Ø2 x Ø39 x Ø43 x 3T x 30L	1	93	SOCKET CAP SCREW M4 x 16	4
16	SPRING SEAT RING Ø35.1 x Ø44.5 x 2	1	94	MOTOR SWITCH	1
17	EXTERNAL CIRCLIP S-35	1	94	MOTOR SWITCH	1
18	INTERNAL CIRCLIP R-47	1	95	MAGNET SWITCH	1
19	BEARING 6005 zz	1	96	GIB STRIP - LEFT	1
20	EXTERNAL CIRCLIP S-25	1	97	GIB STRIP - RIGHT	1
21	SCREW M5 x 65	4	98	GIB TENSIONER 260 x 11 x 2.3	1
22	N/A	-	99	SCREW M4 x 16	1
23	PUSH LOCK FITTING	1	100	STAR WASHER M5	1
24	GEAR CASE	1	101	SPRING WASHER M6	3
25~30	N/A	-	102	MAGNET BASE 164 x 80 x 48	1
31	SLIDE HEIGHT LOCK	1	103	SIDE PANEL	1
32~33	N/A	-	104	SCREW M4 x 8	4
34	LOCK BRACKET	1	105	RECTIFIER	1
35	FLAT HEAD SCREW M4 x 10	4	105-1	RECTIFIER & EMC	1
36	BEARING 608 zz	5	106	CRANK SPINDLE	1
37	INPUT PINION H:M1.0 x 17T	1	107	CRANK LEVER	3
37	INPUT PINION L:M1.0 x 12T	1	108	SCREW M4 x 30	2
38	PARALLEL KEY 4 x 4 x 8	2	109	STRAIN RELIEF 8cm	1
39	INPUT GEAR M1.0 x 36T	1	110	CORD ARMOR	1
40	EXTERNAL CIRCLIP S-10	1	111	POWER SUPPLY CABLE 1.0 x 3C x 2.5M	1
41	OIL SEAL Ø25 x Ø40 x 7	2	112	CABLE GLAND	1
42	OUTPUT GEAR M1.25 x 37T	1	113	N/A	-
43	EXTERNAL CIRCLIP S-15	1	114	LEAD WIRE 18CM	2
44	EXTERNAL CIRCLIP S-12	1	115	LEAD WIRE 18CM	4
45	INTERMEDIATE GEAR PINION M1.25 x 12T	1	116	COMBINATION WRENCH M8	1
46	INTERMEDIATE GEAR H:M1.0 x 40T	1	117	L-HEX KEY M2.5	1
46	INTERMEDIATE GEAR L:M1.0 x 45T	1	118	L-HEX KEY M4	1
47	NEEDLE BEARING HK 0810	1	119	N/A	-
48	N/A	-	120	SAFETY CHAIN	1
49	GEAR PLATE	1	121	OVERLOAD UNIT(OPTIONAL)	1
50	BEARING 6001-LLU	1	121	OVERLOAD UNIT(OPTIONAL)	1
51	ARMATURE 7T	1	122	SOCKET CAP SCREW M6 x 20	3
51	ARMATURE 7T	1	123	TRUSS HEAD SCREW M4 x 6	2
52	SCREW M5 x 60	2	124	MOTOR COVER PLATE	1
53	STATOR	1	125	T-HANDLE HEX KEY M6	1
54	MOTOR HOUSING	1	126	FLAT HEAD SCREW M4 x 8	4
55	NUT M4 x 8	8	127	RUBBER WASHER M4	1
56	BRUSH HOLDER	2	128	SPADE TERMINAL	4
57	CARBON BRUSH 7 x 11 x 17	2	129	SCREW M4 x 25	3
58	BRUSH SPRING	2	130	ZIP TIE	1
59	SCREW M4 x 10	2	131	TERMINAL COVER	8
60	SCREW M4 x 12	4	132	CHIP GUARD	1
61	MOTOR TAIL COVER	1	133	FLAT WASHER Ø6 x Ø13 x 1	2
62	SCREW M4 x 25	2	134	BUTTERFLY SCREW M6 x 10	2
63	CABLE CLIP	2	135	SET SCREW M8 x 7	2
64	SCREW M4 x 14	2	136	CHUCK (OPTIONAL) 1/2"	1
65	END SPLICE TERMINAL C4	3	137	CHUCK ADAPTOR (OPTIONAL) 1/2" 17.4	1
66	CABLE CLAMP	2	138	N/A	-
67	MOTOR CABLE 1.25 x 2C x 65CM	1	139	PILOT PIN (OPTIONAL) HSSx77LxØ6.35(step-pin)	1
68	CABLE PROTECTOR 40cm	1	140	EARTHING MARKING	1
69	COOLANT TUBE 15cm	1	141	FAN BAFFLE	1
70~73	N/A	-			
74	COOLANT TANK ASSEMBLY	1			

Semi Auto Feed Drilling System Exploded View & Parts list

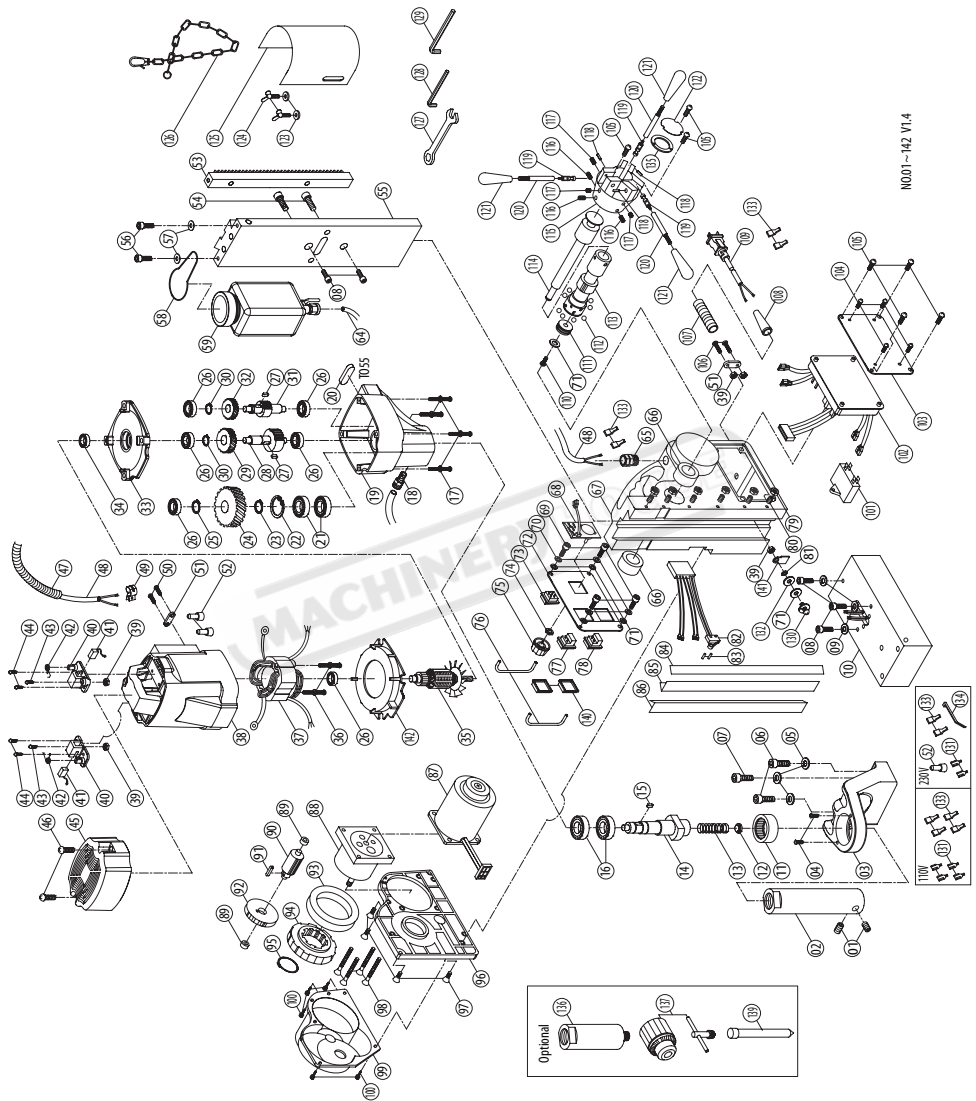

NO.	Parts Name	QTY	74	NUT	1
1	SET SCREW M8 x 7	2	75	SELECTOR SWITCH	1
2	ARBOR	1	76	SWITCH GUARD	2
3	ARBOR SUPPORT BRACKET	1	77	MOTOR ON SWITCH (GREEN)	1
4	TRUSS HEAD SCREW M5 x 8	2	78	MOTOR OFF SWITCH (RED)	1
5	SPRING WASHER M8	3	79	NUT M5	6
6	SOCKET CAP BOLT M8 x 55	2	80	SET SCREW M5 x 20	6
7	SOCKET CAP BOLT M8 x 30	1	81	STAR WASHER M5	1
8	SOCKET CAP BOLT M6 x 20	5	82	LIMIT SWITCH	1
9	SPRING WASHER M6	3	83	PIN Ø2.2 x 10	2
10	MAGNET	1	84	GIB TENSIONER 260 x 11 x 2.3	1
11	BEARING HK 3516	1	85	GIB STRIP - RIGHT	1
12	COOLANT SEAL	1	86	GIB STRIP - LEFT 260L	1
13	SPRING	1	87	FEED MOTOR	1
14	SPINDLE	1	88	FEED MOTOR GEAR BOX	1
15	PARALLEL KEY 5 x 5 x 10	1	89	BUSHING Ø8 x Ø12 x 6	2
16	OIL SEAL Ø28 x Ø40 x 7	2	90	FEED INTERMEDIATE GEAR 10T	1
17	SCREW M5 x 70	4	91	PARALLEL KEY 4 x 4 x 10	1
18	PUSH LOCK FITTING	1	92	FEED OUTPUT GEAR 80T	1
19	GEAR CASE	1	93	BEARING 6809 zz	1
20	PARALLEL KEY 4 x 4 x 30	1	94	ENGAGEMENT GEAR 63T	1
21	BEARING 6003 zz	2	95	EXTERNAL CIRCLIP S-29	1
22	INTERNAL CIRCLIP R-35	1	96	FEED SUPPORT BASE	1
23	EXTERNAL CIRCLIP S-17	1	97	FLAT HEAD SCREW M5 x 15	4
24	OUTPUT GEAR 37T	1	98	FLAT HEAD SCREW M5 x 30	4
25	EXTERNAL CIR CLIP S-15	1	99	AUTO FEED COVER	1
26	BEARING 608 zz	6	100	SCREW M5 x 20	5
27	PARALLEL KEY 4 x 4 x 8	2	101	CAPACITOR	1
28	INTERMEDIATE GEAR PINION 12T	1	101	CAPACITOR	1
29	INTERMEDIATE GEAR 34T	1	102	ELECTRONICS BOARD	1
30	EXTERNAL CIRCLIP S-10	2	102	ELECTRONICS BOARD	1
31	INPUT PINION 9T	1	103	SIDE PLATE	1
32	INPUT GEAR 30T	1	104	SCREW M3.5 x 6	4
33	GEAR PLATE	1	105	SCREW M4 x 8	7
34	BEARING 6001-LLU	1	106	SCREW M4 x 30	2
35	ARMATURE 7T	1	107	CABLE PROTECTOR 7CM	1
35	ARMATURE 7T	1	108	CORD ARMOR	1
36	SCREW M5 x 60	2	109	POWER SUPPLY CABLE	1
37	STATOR	1	110	SCREW M4 x 10	1
37	STATOR	1	111	SELECTOR CAM	1
38	MOTOR HOUSING	1	112	BALL Ø5	8
39	NUT M4 x 8	5	113	CRANK SPINDLE	1
40	BRUSH HOLDER 7 x 11	2	114	SELECTOR ROD	1
41	CARBON BRUSH 7 x 11 x 17	2	115	CRANK HUB	1
42	SPRING	2	116	SET SCREW M8 x 10	3
43	SCREW M4 x 10	2	117	DETENT UNIT M6 x 13	3
44	SCREW M4 x 12	4	118	SPRING PIN Ø4.2 x 25	3
45	MOTOR TAIL COVER	1	119	CRANK LEVER TIP	3
46	SCREW M4 x 25	2	120	CRANK LEVER	3
47	CABLE PROTECTOR 40CM	1	121	CRANK GRIP	3
48	MOTOR CABLE 1.25 x 2C x 80CM	1	122	HUB COVER	1
49	CABLE CLAMP	1	123	FLAT WASHER Ø6 x Ø13 x 1	2
50	SCREW M4 x 14	2	124	BUTTERFLY SCREW M6 x 10	2
51	CORD CLIP	2	125	CHIP GUARD	1
52	WIRE CONNECTOR C-4	3	126	SAFETY CHAIN	1
53	GEAR RACK	1	127	COMBINATION WRENCH M8	1
54	SCREW M8 x 16	2	128	L-HEX KEY M2.5	1
55	SLIDE PLATE	1	129	L-HEX KEY M4	1
56	SOCKET CAP BOLT M5 x 16	2	130	SCREW M4 x 16	1
57	FLAT WASHER Ø5 x Ø12 x 1	2	131	SPADE TERMINAL	4
58	COOLANT TANK BRACKET	1	132	RUBBER WASHER Ø4 x Ø11 x 1	1
59	COOLANT TANK ASSEMBLY	1	133	TERMINAL COVER	8
60~63	N/A	-	134	ZIP TIE	1
64	COOLANT TUBE 15CM	1	135	HUB PLATE	1
65	CABLE GLAND	1	136	CHUCK ADAPTOR	1
66	BUSHING Ø28 x Ø32 x 12	2	137	CHUCK	1
67	STAND BODY	1	138	CHUCK KEY	1
68	SPEED CONTROL BOARD	1	139	PILOT PIN TCTx91LxØ8	1
69	SOCKET CAP SCREW M4 x 16	4	140	SWITCH PROTECTIVE COVER	2
70	SPRING WASHER M4	4	141	EARTHING MARKING	1
71	FLAT WASHER Ø4 x Ø10 x 1	6	142	FAN BAFFLE	1
72	SWITCH PLATE	1			
73	MAGNET SWITCH	1			

2 Speed Drilling System Exploded View & Parts list (High Speed)

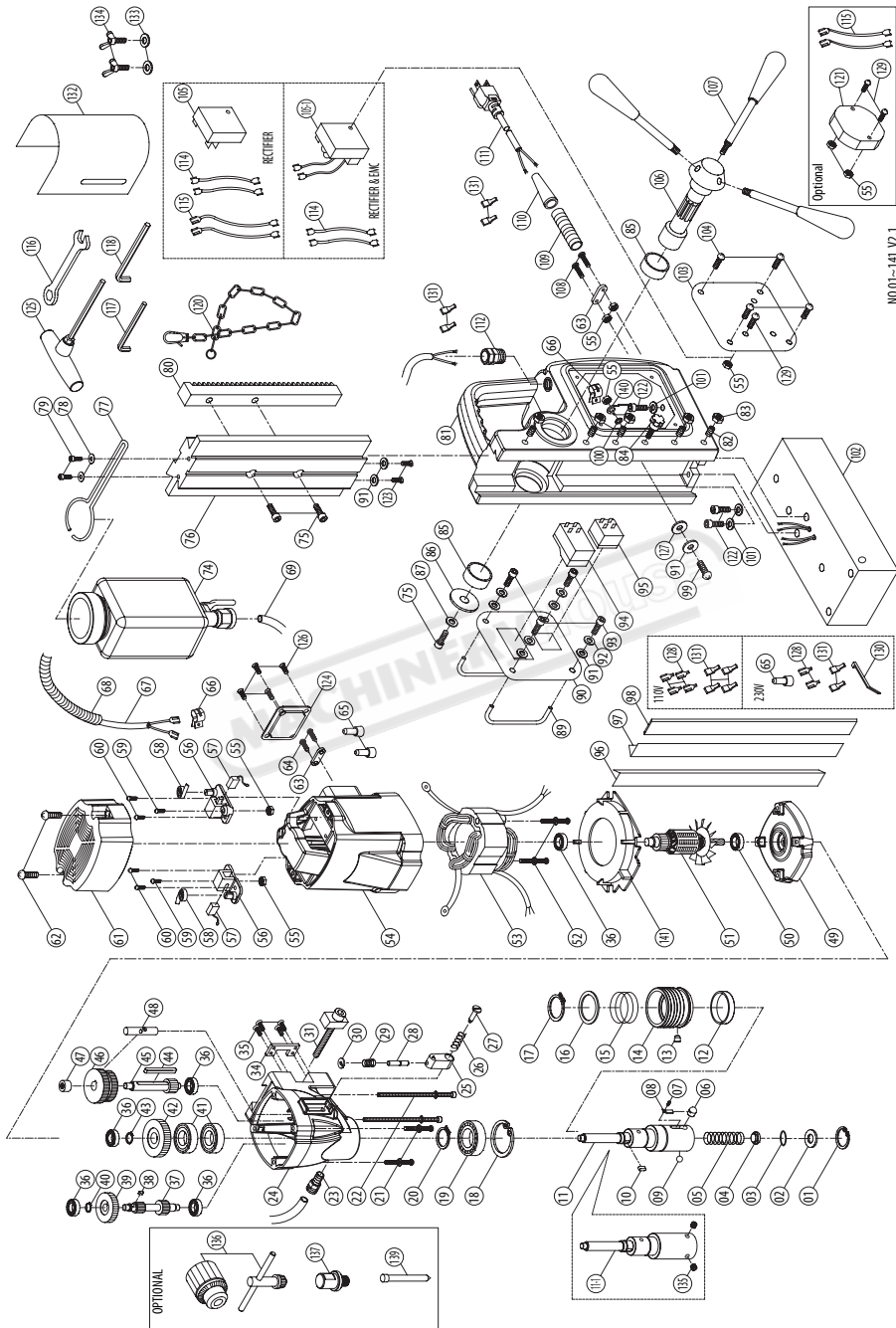

NO.	Parts Name	QTY	70 ~73	N/A	-
1	INTERNAL CIRCLIP R-19	1	74.	COOLANT TANK ASSEMBLY	1
2	ARBOR WASHER Ø10 x Ø18.5 x 0.8	1	75	SOCKET CAP BOLT M6 x 16	3
3	O-RING Ø12 x Ø20 x 4	1	76	SLIDE	1
4	COOLANT SEAL	1	77	COOLANT TANK BRACKET	1
5	SPRING Ø1.2 x Ø10.1 x Ø12.5 x 12T x 90L	1	78	FLAT WASHER Ø5 x Ø12 x 1	2
6	LOCKING PIN 12.3mm	1	79	SOCKET CAP SCREWM5 x 16	2
6	LOCKING PIN 11.7mm	1	80	GEAR RACK	1
7	SCREW M3 x 4	1	81	STAND BODY	1
8.	LOCKING PIN SPRING	1	82	GIB SET SCREW M5 x 20	5
9	CHECK BALL Ø8	1	83	GIB LOCK NUT M5	5
10	PARALLEL KEY 5 x 5 x 10	1	84	THUMB SCREW M5 x 16	1
11	SPINDLE	1	85	BUSHING Ø28 x Ø32 x 12	2
11-1	SPINDLE	1	86	FLAT WASHER Ø6 x Ø40 x 2.5	1
12	RING Ø40 x Ø44 x 9	1	87	FLAT WASHER Ø6 x Ø25 x 1	1
13	COLLAR PIN	1	88	N/A	-
14	QUICK-RELEASE COLLAR	1	89	SWITCH GUARD BAR	2
15	SPRING Ø2 x Ø39 x Ø43 x 3T x 30L	1	90	SWITCH PANEL	1
16	SPRING SEAT RING Ø35.1 x Ø44.5 x 2	1	91	FLAT WASHER Ø4 x Ø10 x 1	7
17	EXTERNAL CIRCLIP S-35	1	92	SPRING WASHER M4	4
18	INTERNAL CIRCLIP R-47	1	93	SOCKET CAP SCREW M4 x 16	4
19	BEARING 6005 zz	1	94	MOTOR SWITCH	1
20	EXTERNAL CIRCLIP S-25	1	95	MAGNET SWITCH	1
21	SCREW M5 x 65	2	96	GIB STRIP - LEFT	1
22	SCREW M5 x 110	2	97	GIB STRIP - RIGHT	1
23	PUSH LOCK FITTING	1	98	GIB TENSIONER 260 x 11 x 2.3	1
24	GEAR CASE	1	99	SCREW M4 x 16	1
25	SELECTOR TAB	1	100	STAR WASHER M5	1
26	SPRING Ø1 x Ø9 x Ø11 x 4T x 10.5L	1	101	SPRING WASHER M6	3
27	SHOULDER SCREW	1	102	MAGNET BASE	1
28	DETENT PIN	1	103	SIDE PANEL	1
29	SPRING Ø0.6 x Ø5.3 x Ø6.5 x 5T x 17L	1	104	SCREW M4 x 8	4
30	E-CLIP E-3	1	105	RECTIFIER	1
31	SLIDE HEIGHT LOCK	1	105-1	RECTIFIER & EMC	1
32	N/A	-	106	CRANK SPINDLE	1
33	N/A	-	107	CRANK LEVER	3
34	LOCK BRACKET	1	108	SCREW M4 x 30	1
35	FLAT HEAD SCREW M4 x 10	4	109	STRAIN RELIEF 7cm	2
36	BEARING 608 zz	5	110	CORD ARMOR	1
37	INPUT PINION M1.0 x 12T & 17T	1	111	POWER SUPPLY CABLE 1.0 x 3C x 2.5M	1
38	PARALLEL KEY 4 x 4 x 8	1	112	CABLE GLAND	1
39	INPUT GEAR M1.0 x 36T	1	113	N/A	-
40	EXTERNAL CIRCLIP S-10	1	114	LEAD WIRE 18CM	2
41	OIL SEAL Ø25 x Ø40 x 7	2	115	LEAD WIRE 18CM	4
42	OUTPUT GEAR M1.25 x 37T	1	116	COMBINATION WRENCH M8	1
43	EXTERNAL CIRCLIP S-15	1	117	L-HEX KEY M2.5	1
44	PARALLEL KEY M5 x 5 x 50	1	118	L-HEX KEY M4	1
45	INTERMEDIATE GEAR PINION M1.25 x 12T	1	119	N/A	-
46	INTERMEDIATE GEAR M1.0 x 45T & 40T	1	120	SAFETY CHAIN	1
47	NEEDLE BEARING HK 0810	1	121	OVERLOAD UNIT(OPTIONAL)	1
48	SELECTOR FORK	1	122	SOCKET CAP BOLT M6 x 20	3
49	GEAR PLATE	1	123	TRUSS HEAD SCREW M4 x 6	2
50	BEARING 6001-LLU	1	124	MOTOR COVER PLATE	1
51	ARMATURE 7T	1	125	T-HANDLE HEX KEY M6	1
52	SCREW M5 x 60	2	126	FLAT HEAD SCREW M4 x 8	4
53	STATOR	1	127	RUBBER WASHER M4	1
54	MOTOR HOUSING	1	128	TERMINAL	4
55	NUT M4 x 8	8	129	SPADE TERMINAL M4 x 25	3
56	BRUSH HOLDER	2	130	ZIP TIE	1
57	CARBON BRUSH 7 x 11 x 17	2	131	TERMINAL COVER	8
58	BRUSH SPRING	2	132	CHIP GUARD	1
59	SCREW M4 x 10	2	133	FLAT WASHER Ø6 x Ø13 x 1	2
60	SCREW M4 x 12	4	134	BUTTERFLY SCREW M6 x 10	2
61	MOTOR TAIL COVER	1	135	SET SCREW M8 x 7	2
62	SCREW M4 x 25	2	136	CHUCK (OPTIONAL) 1/2"	1
63	CABLE CLIP	2	137	CHUCK ADAPTOR (OPTIONAL) 1/2"	1
64	SCREW M4 x 14	2	138	N/A	-
65	END SPLICE TERMINAL C4	3	139	PILOT PIN (OPTIONAL) HSSx77Lxp6.35(step-pin)	1
66	CABLE CLAMP	2	140	EARTHING MARKING	1
67	MOTOR CABLE 1.25 x 2C x 65CM	1	141	FAN BAFFLE	1
68	CABLE PROTECTOR 40cm	1			
69	COOLANT TUBE 15cm	1			

2 Speed Drilling System Exploded View & Parts list (Low Speed)

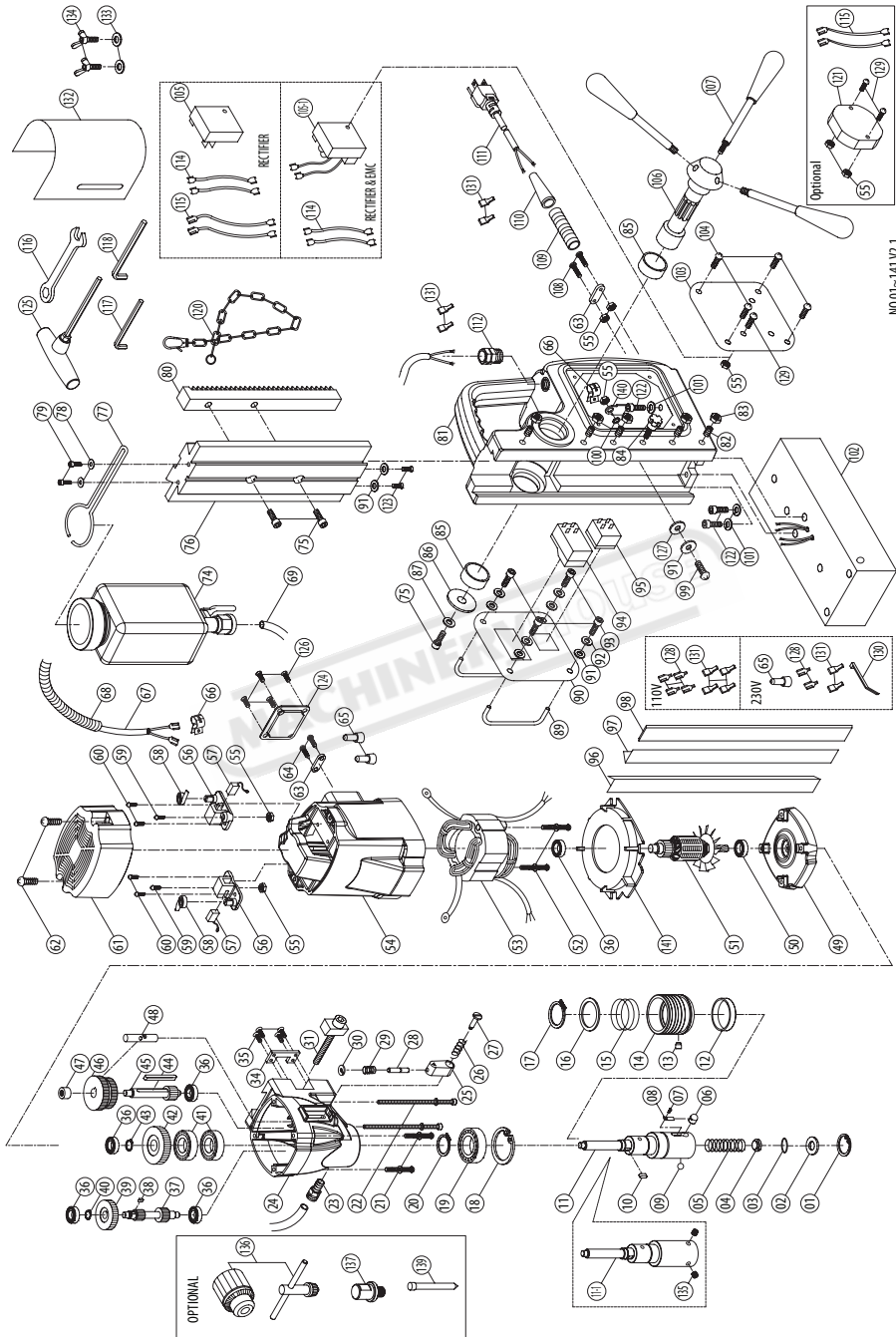

NO.	Parts Name	Q'TY	74	COOLANT TANK ASSEMBLY	1
1	INTERNAL CIRCLIP R-19	1	75	SOCKET CAP BOLT M6 x 16	3
2	ARBOR WASHER Ø10 x Ø18.5 x 0.8	1	76	SLIDE	1
3	O-RING Ø12 x Ø20 x 4	1	77	COOLANT TANK BRACKET	1
4	COOLANT SEAL	1	78	FLAT WASHER Ø5 x Ø12 x 1	2
5	SPRING Ø1.2 x Ø10.1 x Ø12.5 x 12T x 90L	1	79	SOCKET CAP SCREW M5 x 16	2
6	LOCKING PIN 12.3mm	1	80	GEAR RACK	1
6	LOCKING PIN 11.7mm	1	81	STAND BODY	1
7	SCREW M3 x 4	1	82	GIB SET SCREW M5 x 20	5
8	LOCKING PIN SPRING	1	83	GIB LOCK NUT M5	5
9	CHECK BALL Ø8	1	84	THUMB SCREW M5 x 16	1
10	PARALLEL KEY 5 x 5 x 10	1	85	BUSHING Ø28 x Ø32 x 12	2
11	SPINDLE	1	86	FLAT WASHER Ø6 x Ø40 x 2.5	1
11-1	SPINDLE	1	87	FLAT WASHER Ø6 x Ø25 x 1	1
12	RING Ø40 x Ø44 x 9	1	88	N/A	-
13	COLLAR PIN	1	89	SWITCH GUARD BAR	2
14	QUICK-RELEASE COLLAR	1	90	SWITCH PANEL	1
15	SPRING Ø2 x Ø39 x Ø43 x 3T x 30L	1	91	FLAT WASHER Ø4 x Ø10 x 1	7
16	SPRING SEAT RING Ø35.1 x Ø44.5 x 2	1	92	SPRING WASHER M4	4
17	EXTERNAL CIRCLIP S-35	1	93	SOCKET CAP SCREW M4 x 16	4
18	INTERNAL CIRCLIP R-47	1	94	MOTOR SWITCH	1
19	BEARING 6005 zz	1	95	MAGNET SWITCH	1
20	EXTERNAL CIRCLIP S-25	1	96	GIB STRIP - LEFT	1
21	SCREW M5 x 65	2	97	GIB STRIP - RIGHT	1
22	SCREW M5 x 110	2	98	GIB TENSIONER 260 x 11 x 2.3	1
23	PUSH LOCK FITTING	1	99	SCREW M4 x 16	1
24	GEAR CASE	1	100	STAR WASHER M5	1
25	SELECTOR TAB	1	101	SPRING WASHER M6	3
26	SPRING Ø1 x Ø9 x Ø11 x 4T x 10.5L	1	102	MAGNET BASE	1
27	SHOULDER SCREW	1	103	SIDE PANEL	1
28	DETENT PIN	1	104	SCREW M4 x 8	4
29	SPRING Ø5.3 x Ø6.5 x 5T x 17L	1	105	RECTIFIER	1
30	E-CLIP E-3	1	105-1	RECTIFIER & EMC	1
31	SLIDE HEIGHT LOCK	1	106	CRANK SPINDLE	1
32~33	N/A	-	107	CRANK LEVER	3
34	LOCK BRACKET	1	108	SCREW M4 x 30	2
35	FLAT HEAD SCREW M4 x 10	4	109	STRAIN RELIEF 7cm	1
36	BEARING 608 zz	5	110	CORD ARMOR	1
37	INPUT PINION M1.0 x 11T & 15T	1	111	POWER SUPPLY CABLE 1.0 x 3C x 2.5M	1
38	PARALLEL KEY 4 x 4 x 8	1	112	CABLE GLAND	1
39	INPUT GEAR M1.0 x 36T	1	113	N/A	-
40	EXTERNAL CIRCLIP S-10	1	114	LEAD WIRE 18CM	2
41	OIL SEAL Ø25 x Ø40 x 7	2	115	LEAD WIRE 18CM	4
42	OUTPUT GEAR M1.25 x 39T	1	116	COMBINATION WRENCH M8	1
43	EXTERNAL CIRCLIP S-15	1	117	L-HEX KEY M2.5	1
44	PARALLEL KEY M5 x 5 x 50	1	118	L-HEX KEY M4	1
45	INTERMEDIATE GEAR PINION M1.25 x 10T	1	119	N/A	-
46	INTERMEDIATE GEAR M1.0 x 46T & 42T	1	120	SAFETY CHAIN	1
47	NEEDLE BEARING HK 0810	1	121	OVERLOAD UNIT(OPTIONAL)	1
48	SELECTOR FORK	1	122	SOCKET CAP BOLT M6 x 20	3
49	GEAR PLATE	1	123	TRUSS HEAD SCREW M4 x 6	2
50	BEARING 6001-LLU	1	124	MOTOR COVER PLATE	1
51	ARMATURE 7T	1	125	T-HANDLE HEX KEY M6	1
52	SCREW M5 x 60	2	126	FLAT HEAD SCREW M4 x 8	4
53	STATOR	1	127	RUBBER WASHER M4	1
54	MOTOR HOUSING	1	128	SPADE TERMINAL	4
55	NUT M4 x 8	8	129	SCREW M4 x 25	3
56	BRUSH HOLDER	2	130	ZIP TIE	1
57	CARBON BRUSH 7 x 11 x 17	2	131	TERMINAL COVER	8
58	BRUSH SPRING	2	132	CHIP GUARD	1
59	SCREW M4 x 10	2	133	FLAT WASHER Ø6 x Ø13 x 1	2
60	SCREW M4 x 12	4	134	BUTTERFLY SCREW M6 x 10	2
61	MOTOR TAIL COVER	1	135	SET SCREW M8 x 7	2
62	SCREW M4 x 25	2	136	CHUCK (OPTIONAL) 1/2"	1
63	CABLE CLIP	2	137	CHUCK ADAPTOR (OPTIONAL) 1/2"	1
64	SCREW M4 x 14	2	138	N/A	-
65	END SPLICE TERMINAL C4	3	139	PILOT PIN (OPTIONAL) HSSx77LxØ6.35(step-pin)	1
66	CABLE CLAMP	2	140	EARTHING MARKING	1
67	MOTOR CABLE 1.25 x 2C x 65CM	1	141	FAN BAFFLE	1
68	CABLE PROTECTOR 40cm	1			
69	COOLANT TUBE 15cm	1			
70~73	N/A	-			

NO.	Parts Name	Q'TY	NO.	Parts Name	Q'TY
1	INTERNAL CIRCLIP R-19	1	83	RHEOSTAT	1
2	ARBOR WASHER 010 x 018.5 x 0.8	1	84	THUMB WHEEL	1
3	O-RING 12 x 4	1	85	SPEED ADJUSTOR COVER	1
4	COOLANT SEAL 012 x 010.2 x 15	1	86	FLAT HEAD SCREW M4 x 16	2
5A	SPRING-for 10B.) 01.2 x 010.1 x 012.5 x 15T x 100L	1	87	CABLE PROTECTOR 65cm	1
5B	SPRING-for 10C.) 01.2 x 010 x 012.4 x 24T x 140L	1	88	MOTOR CABLE 90cm	1
6-9	N/A	-	89	SCREW M5 x 10	4
10A	3/4" QUICK-RELEASE ARBOR-MT3 MT3(LOCKING PIN 12.3mm,11.7mm)	1	90	COVER PLATE	1
10B	1-1/4" CUTTER ARBOR-MT3 31.7mm	1	91	SCREW M4 x 16	2
10C	3/4" CUTTER ARBOR-MT3 19MM	1	92	CORD CLIP	2
11-15	N/A	-	93	CABLE SHEATH M4 x 12CM	2
16	EXTERNAL CIRCLIP S-35	1	94	COOLANT TANK ASSEMBLY	1
17	SPINDLE	1	95	COOLANT TUBE 40cm	1
18	OIL SEAL 040 x 058 x 8	1	96	SOCKET CAP BOLT M8 x 20	7
19	OIL SEAL 040 x 055 x 7	1	97	SLIDE	1
20	INTERNAL CIRCLIP R-55	1	98	SOCKET CAP BOLT M8 x 16	7
21	BALL BEARING 6006-LLB	2	99	SPRING WASHER M8	7
22	EXTERNAL CIRCLIP S-30	1	100	GEAR RACK 270cm	1
23	SCREW M5 x 80	2	101	REVERSING SWITCH	1
24	SCREW M5 x 150	2	102	MAGNET SWITCH	1
25	GEAR CASE	1	103	GUARD BAR	2
26	PUSH LOCK FITTING	1	104	SWITCH PANEL	1
27	MOUNTING TENON M4 x 4 x 60	1	105	FLAT WASHER 04 x 010 x 1	5
28	SELECTOR TAB	2	106	SPRING WASHER M4	4
29	SPRING 01 x 09 x 011 x 4T	2	107	SOCKET CAP BOLT M4 x 16	4
30	SHOULDER SCREW	2	108	SCREW M4 x 20	2
31	DETENT PIN	1	109	MOTOR SWITCH	1
32	SPRING 00.6 x 05.3 x 06.5 x 5T x 17L	2	110	FLAT WASHER 08 x 040 x 2.5	1
33	E-CLIP E-3	2	111	CRANK BUSHING 032 x 038 x 12	2
34	DETENT PIN	1	112	STAND BODY	1
35	DISC SPRING 012.4 x 027.9	4	113	SET SCREW M5 x 35	7
36	TOOTH CLUTCH	1	114	NUT M5	7
37	CLUTCH GEAR	1	115	STAR WASHER M5	1
38	THRUST WASHER 012.1 x 018 x 1.6	1	116	EARTHING MARKING	1
39	EXTERNAL CIRCLIP E-10	1	117	SCREW M4 x 16	1
40	BALL BEARING 608 zz	3	118	N/A	-
41	INPUT PINION M1.25 x 15T & 10T	1	119	GIB STRIP-LEFT 394mm	1
42	PARALLEL KEY M5 x 5 x 10	1	120	GIB STRIP-RIGHT 394mm	1
43	OIL SEAL 028 x 038 x 7	1	121	GIB STRIP TENSIONER 394 x 15 x 1.2	1
44	FIRST SELECTOR FORK	1	122	CABLE GLAND	1
45	SPINDLE GEAR M1.75 x 27T M2.0 x 29T	1	123	N/A	-
46	INTERNAL CIRCLIP S-25	1	124	SPRING WASHER M6	4
47	BALL BEARING 6202 zz	1	125	MAGNET BASE	1
48	SECOND SELECTOR FORK	1	126	SCREW M4 x 30	2
49	INTERMEDIATE GEAR M1.25 x 27T & 32T	1	127	STRAIN RELIEF 7CM	1
50	PARALLEL KEY 5 x 5 x 45	1	128	CORD ARMOR	1
51	COUNTERSHAFT PINION 12T	1	129	TERMINAL COVER	12
52	BALL BEARING 6200 zz	2	130	POWER SUPPLY CABLE	1
53	IDLER PINION M1.75 x 17T M2.0 x 9T	1	131A	RECTIFIER & EMC(OPTIONAL)	1
54	PARALLEL KEY M5 x 5 x 8	1	131B	RECTIFIER & EMC(OPTIONAL)	1
55	IDLER GEAR M1.25 x 43T	1	131B	RECTIFIER & EMC(OPTIONAL)	1
56	NEEDLE BEARING TLA 1212	1	132	WIRE LEADS	2
57	GEAR PLATE	1	133	WIRE LEADS(OPTIONAL) 1015-16#18CM	2
58	BALL BEARING 6202-2NSE	1	134	SIDE COVER	1
59	ARMATURE	1	135	SCREW M4 x 8	4
60	BALL BEARING 6200-LLU	1	136	SCREW M4 x 25	1
61	SPACER 08 x 012 x 10.5	1	137	CRANK PINION	1
62	PICKUP MAGNET 08 x 015 x 5	1	138	CRANK HANDLE	3
63	PLASTIC WASHER 04 x 011 x 1	2	139	3 WAY CONNECTOR	2
64	FLAT WASHER 04 x 010 x 1	1	140	WIRE LEADS	2
65	SCREW M4 x 10	1	141	SPADE TERMINAL	10
66	SCREW M5 x 60	2	142	ZIP TIE	1
67	STATOR	1	143	DRIFT	1
68	WIRE LEADS	1	144	L HEX KEY (OPTIONAL) 5mm M5	1
69	WIRE LEADS	1	145	N/A	-
70	MOTOR HOUSING	1	146	L HEX KEY 2.5mm M2.5	1
71	ZIP TIE 2.5mmX160mm	2	147	M8 COMBINATION WRENCH M8	1
72	END SPLICE CONNECTOR C4	5	148	SAFETY CHAIN	1
73	ELECTRONICS UNIT(110V,220V)	1	149	SOCKET SET SCREW M10 x 10	2
74	SCREW M4 x 25	2	150	CHUCK(OPTIONAL) 5/8"	1
75	NUT M4 x 8	8	151	PILOT PIN(OPTIONAL) TCTx112Lx08	1
76	CARBON BRUSH 7 x 17 x 17	2	152	MT3 CHUCK ADAPTOR(OPTIONAL)	1
77	BRUSH HOLDER 7 x 17 x 17	2	153	BUTTERFLY BOLT M6 x 10	2
78	BRUSH SPRING	2	154	FLAT WASHER 06 x 013 x 1	2
79	SCREW M4 x 10	2	155	CHIP GUARD	1
80	SCREW M4 x 12	4	156	FLAT HEAD SCREW M4 x 20	2
81	MOTOR TAIL COVER	1	157	PIN 05 x 10	1
82	SCREW M4 x 30	4	158	INTERNAL CIRCLIP S-20	1